

Flat plate collector with selective surface

The selective absorber surface is made of tube to fin pattern welded by Ultrasonic machine. Compared to the sandwich type, it reaches a higher efficiency in cloudy weather.

The Calpak Selective fits into the same frame as the collector Calpak GIGA 200G, with a surface of 2 m², and 250G, with a surface of 2,5 m². There are three versions in our range, in order to give the maximum flexibility to the installation.

Demonstrative cut

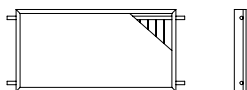
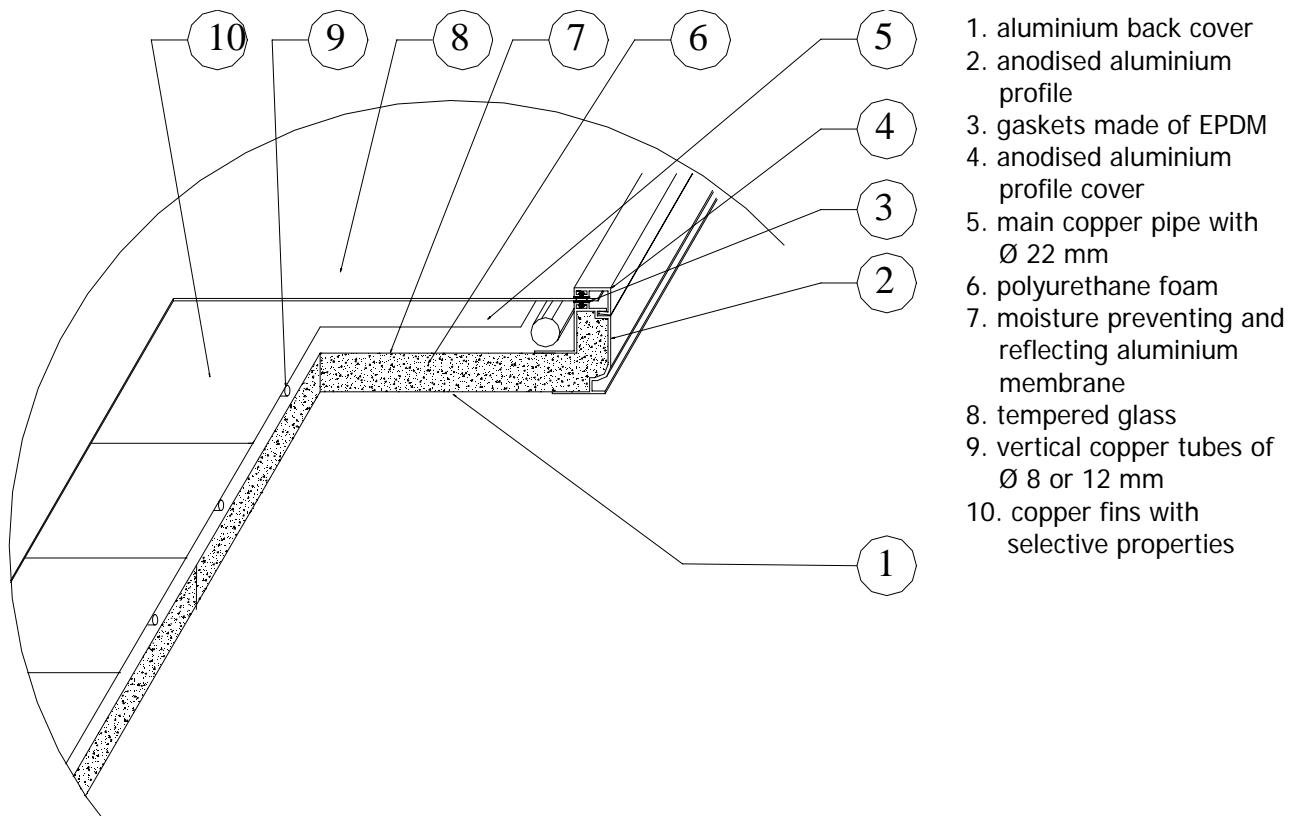

Horizontal version (low-boy)
with D = 8 mm vertical tubes

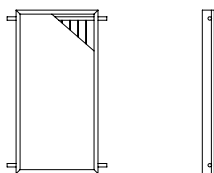

Vertical version
with D = 8 mm vertical tubes

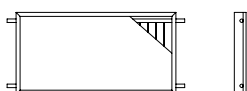

Horizontal version
with D = 12 mm vertical tubes
for low friction

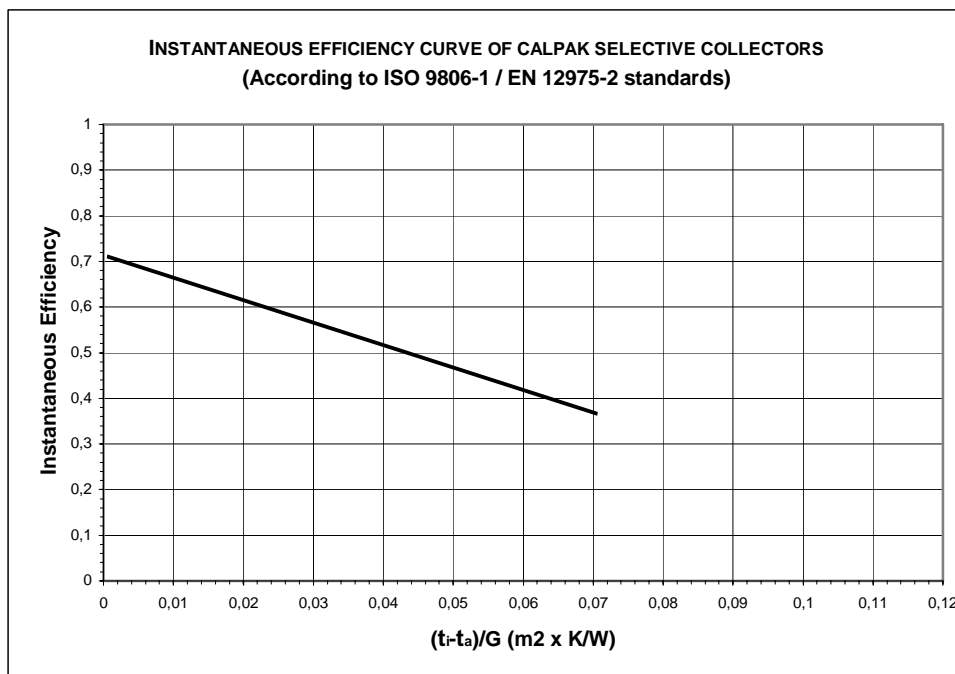

Technical characteristics

Vertical / horizontal version	200GS8V	240GS8V
Collector:		
External dimensions: length / width	2060 mm	2340 mm
width / length	1060 mm	1060 mm
height	95 mm	95 mm
Weight	33,5 kg	40 kg
Gross area	2,18 m ²	2,5 m ²
Cover material	Tempered glass	
Absorber:		
Absorber area	2 m ²	2,28 m ²
Construction type	Wing absorber	
Material	Selective copper fin 0,2 mm and copper tube D = 8 mm (horizontal version also with D = 12 mm)	
Surface treatment	Type BRILLANTA – sputtered copper-chrome-carbon compound	
Absorption coefficient	a > 0,95	
Emission coefficient	e < 0,05	
Fluid content	1,5 l	2 l
Insulation and casing:		
Insulation material	Polyurethane	
Insulation thickness	40-45 kg/m ³ , 30-35 mm thick	
Casing material (framework/back cover)	Anodised aluminium	
Sealing material	EPDM	
Diameter of connections	D = 22 mm	
Limitations:		
Maximum temperature of operation	175 °C	
Maximum operating pressure	10 bar	
Output for Germany (Würzburg)	540 kWh/m ² /year	
Certification:		
EN 12975-2 / ISO 9806-1 – Solar Keymark		