

Flat plate collector sandwich type

The absorber of the flat plate collector "sandwich type" is made of 0,8 mm thick steel, painted in special solar black colour to maximize the absorption of the solar radiation.

This collector is available in three different sizes: 1,53 m², 2,18 m² and 2,50 m². It is therefore adaptable to any combination, according to space requirements and total surface needed.

Its efficiency is excellent and can be best exploited in sunny weather.

Demonstrative cut

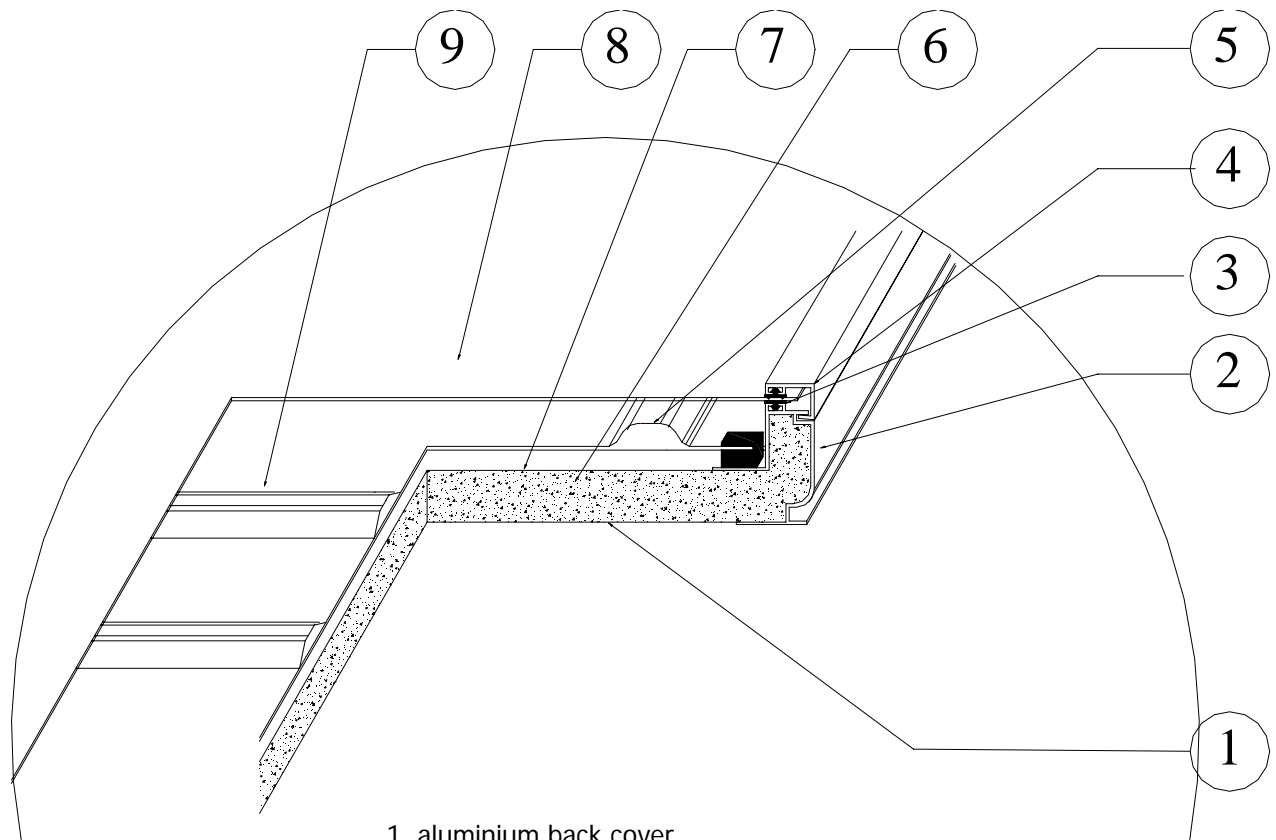

1. aluminium back cover
2. anodised aluminium profile
3. gaskets made of EPDM
4. anodised aluminium profile cover
5. main water channel
6. polyurethane foam
7. moisture preventing and reflecting aluminium membrane
8. tempered glass
9. vertical water channel

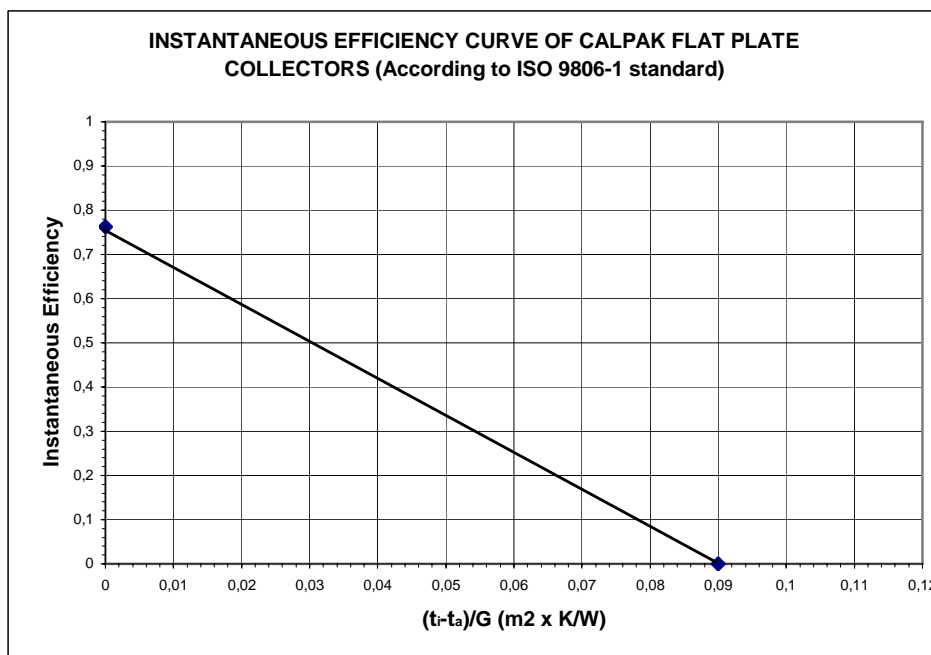

Technical characteristics

| | 150G | 200G | 240G |
|--|--|----------------------|----------------------|
| Collector: | | | |
| External dimensions: | | | |
| length | 1440 mm | 2060 mm | 2340 mm |
| width | 1060 mm | 1060 mm | 1060 mm |
| height | 95 mm | 95 mm | 95 mm |
| Weight | 45 kg | 55 kg | 66 kg |
| Gross area | 1,650 m ² | 2,180 m ² | 2,690 m ² |
| Cover material | Tempered glass | | |
| Absorber: | | | |
| Absorber area | 1,4 m ² | 2 m ² | 2,28 m ² |
| Construction type | "Sandwich" | | |
| Material | Steel sheet ST 12-03, 0,8 mm thick | | |
| Surface treatment | Black paint | | |
| Fluid content | 3,75 l | 5 l | 6,2 l |
| Insulation and casing: | | | |
| Insulation material | Polyurethane | | |
| Insulation thickness | 40-45 kg/m ³ , 30-35 mm thick | | |
| Casing material (framework/back cover) | Anodised aluminium | | |
| Sealing material | EPDM | | |
| Diameter of connections | D = 22 mm | | |
| Limitations: | | | |
| Maximum operating pressure | 1,5 bar | | |
| Breaking pressure | 3 bar | | |
| Output for Germany (Würzburg) | 485 kWh/m ² /year | | |
| Certification: | | | |
| En-12975-2, ISO 9806-1 and 9806-2, Solar Keymark | | | |